

*elan*

# NEW ELAN 400 *PRESS RELEASE*



Begunje na Gorenjskem, 9.11.2012

*elan*



Coming from the drawing boards of Humphreys Design studio her hull is based on their experience in designing offshore racers and VOR Yachts.

Inheriting the qualities of her predecessor Elan 410 and adding some exciting new features from immensely successful Elan 350 (2011 European Yacht of the Year award winner) such as twin rudders and hard chines, Elan 400 is fast and elegant new sailboat with which Elan continues to set new standards in the 40-foot segment.

A new performance cruiser from Elan is to be launched at Boot Düsseldorf in January 2013.

# elan

---

- Humphreys Yacht Design based on experience in offshore racers from Whitbread, Volvo Ocean Race, Open 40 and America's Cup.
- Wide Stern, twin rudder and hard chine for more safety, easier handling and better performance.
- Best possible vacuum packed sandwich lamination construction - VAIL (Vacuum Assisted Infusion Lamination).
- Spacious Cockpit with floor lifting table, transom platform and transom beam gangway.
- Smart innovative interior with 2 layouts (1 or 2 heads) and flip-up chart table for more comfort.
- Modern and spacious interior with attention to ergonomics and storage space optimization and customization.
- Flush Skyview hatches for more light and visibility with new hull window design.



Self folding cascade companionway entrance door (standard)

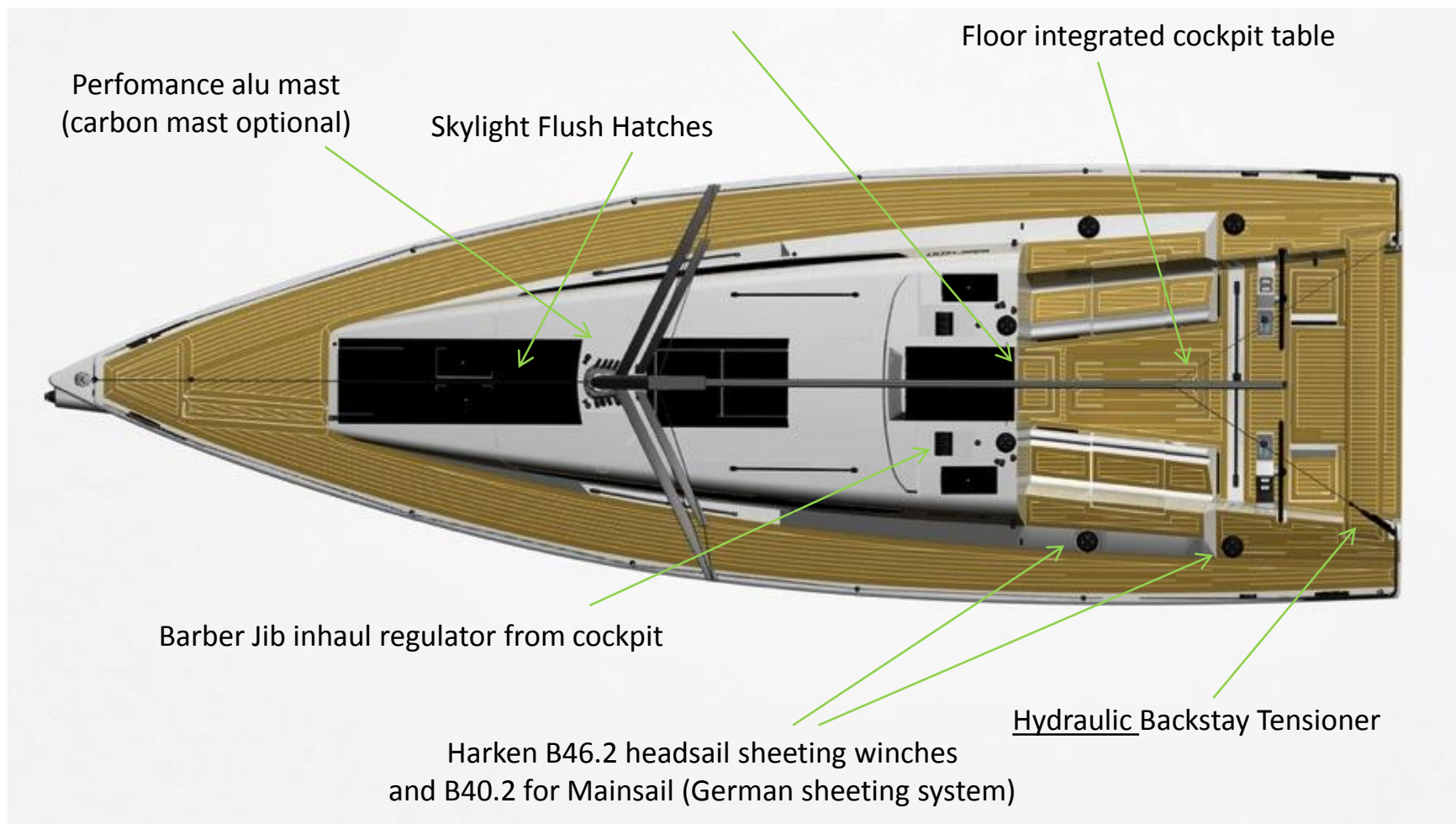

*elan*

## DECK FEATURES

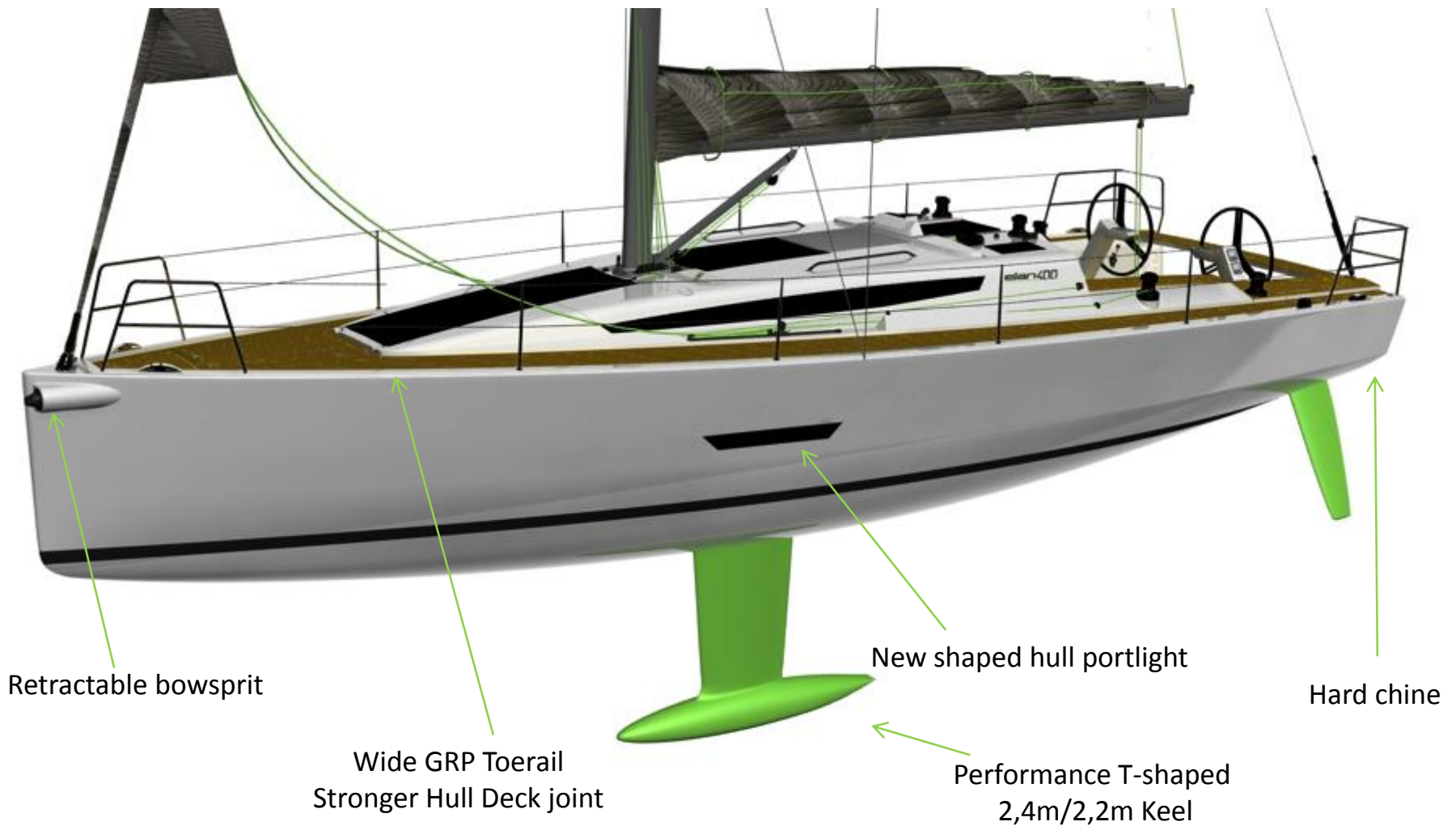



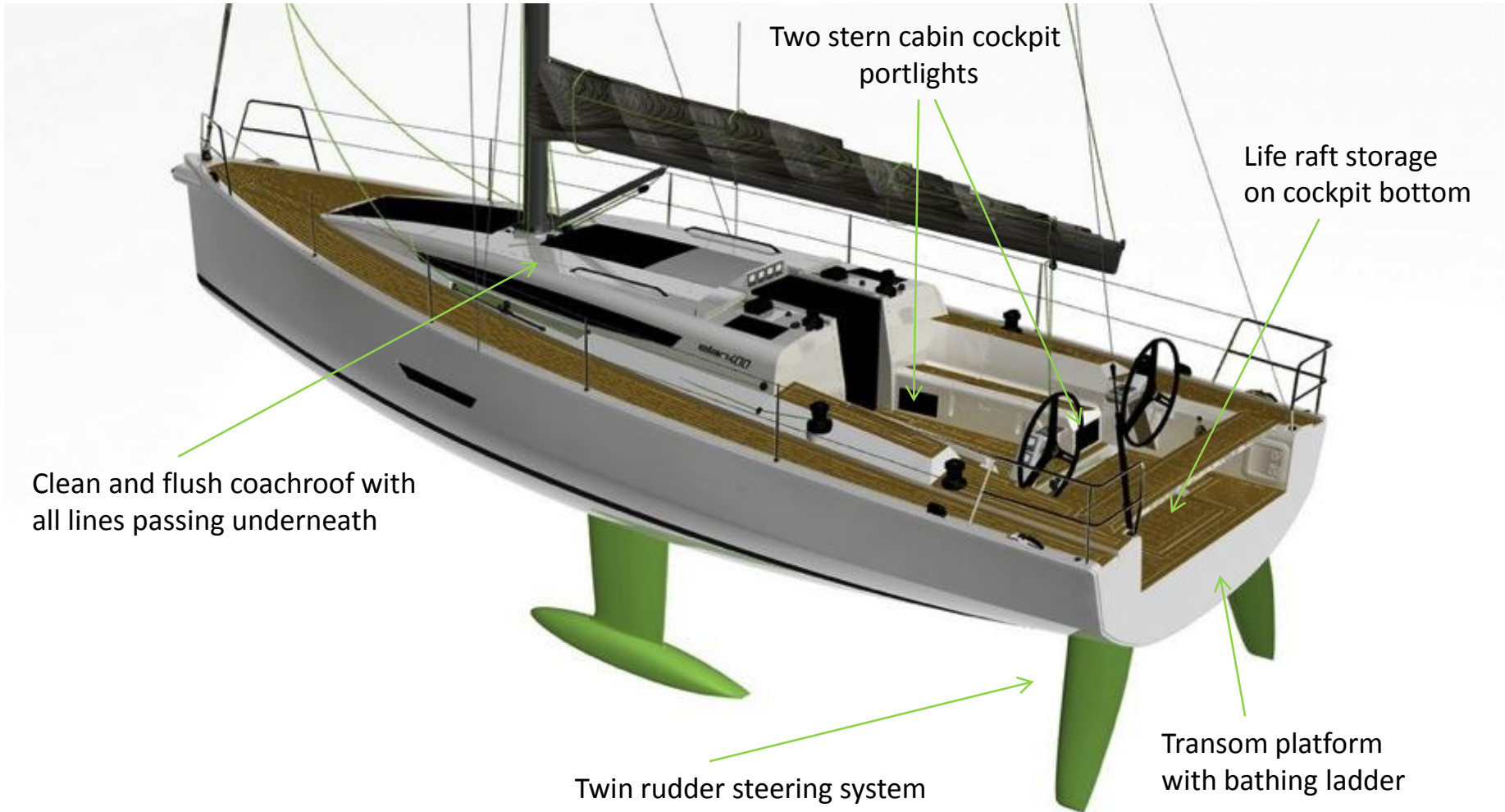



Floor integrated cockpit table

Folding transom platform with swimm ladder

Modern, spacious interior with attention to ergonomics and storage space optimization.

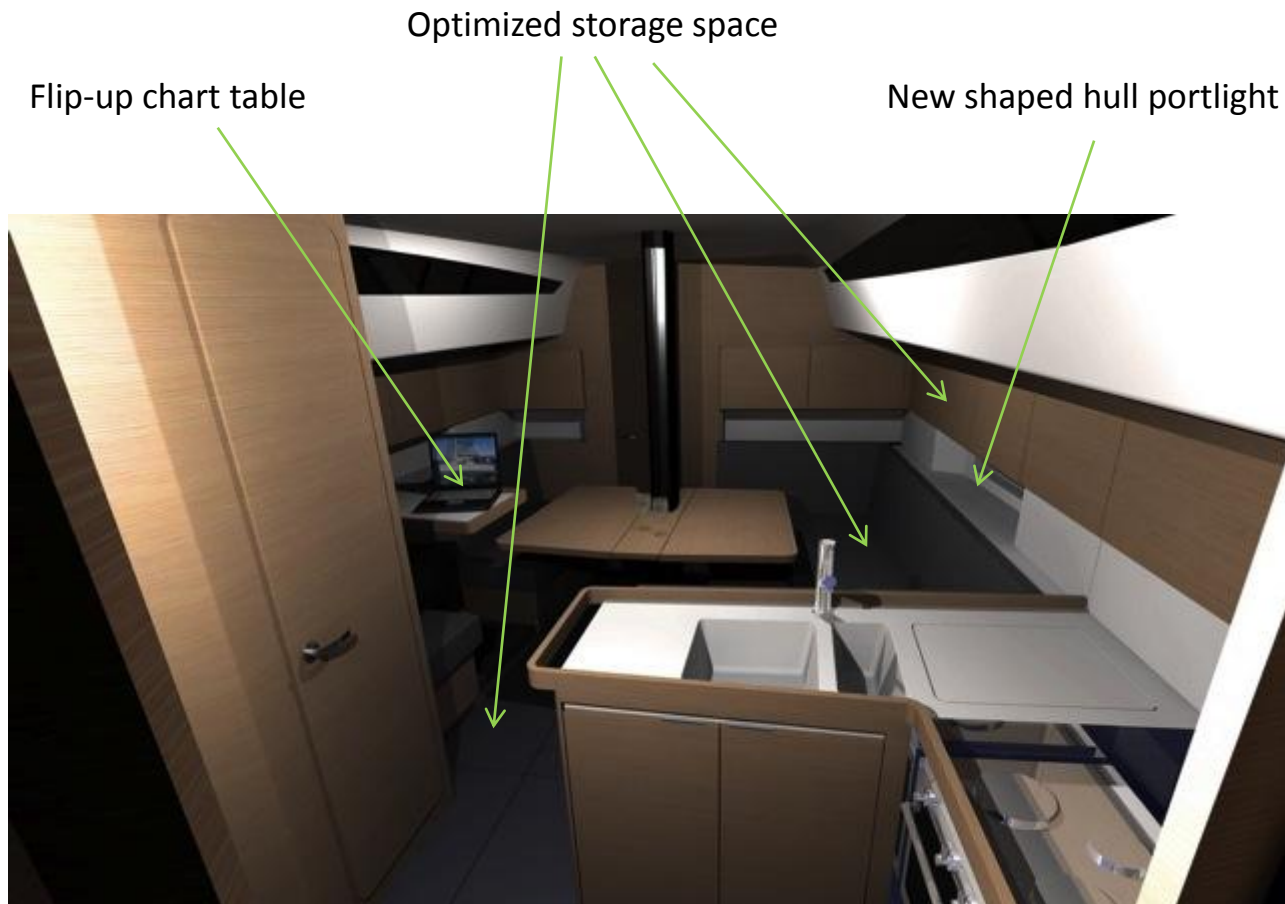



3 cabins  
1 head layout



3 cabins  
2 heads layout

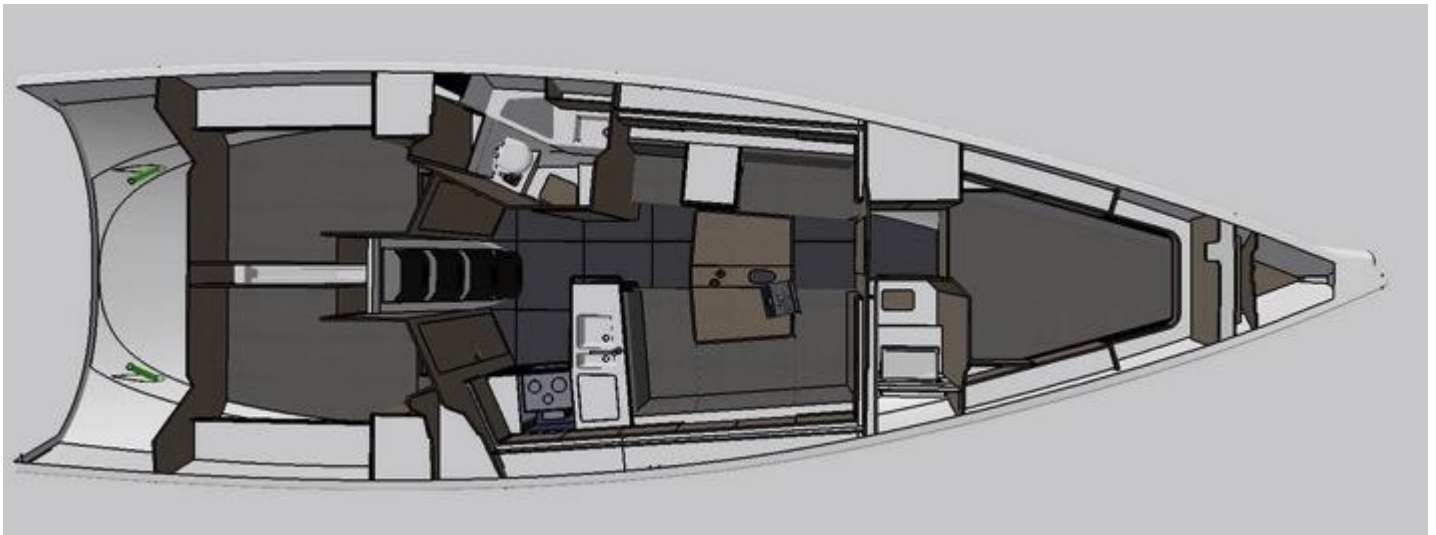

*elan*

---

## TECHNICAL DATA

Length Overall (LOA)	11,95 m
Hull Length	11,95
Length at waterline (LWL)	11,26 m
Beam (max)	3,87 m
Draft	2,40 m std. / 2,20 m opt.
Displacement	7500 kg
Ballast	2700kg
Water capacity	310 l
Fuel Capacity	170 l
Engine	29,4 Kw / 40HP
Mainsail	51,56 m <sup>2</sup>
Genoa (107%)	37.6m <sup>2</sup>
Gennaker	135sqm
Boat design category CE	A
Design	Humphreys Yacht Design & Elan Design Team
Interior Design:	Gigo Design



The logo for Elan, featuring the word "elan" in a stylized, italicized, lowercase font. The letters are grey with a white outline, giving it a three-dimensional appearance. Below the text is a thick, solid green horizontal bar.

[WWW.ELAN-YACHTS.COM](http://WWW.ELAN-YACHTS.COM)

For further information please contact:

Luka Modrijan  
*Director of Nautical Division*  
P: + 386 4 53 51 363  
E: [luka.modrijan@elan.si](mailto:luka.modrijan@elan.si)

Elan d.o.o.  
Begunje 1  
4275 Begunje na Gorenjskem  
Slovenia  
[www.elansports.com](http://www.elansports.com)